

STEEL PALISADE FENCING

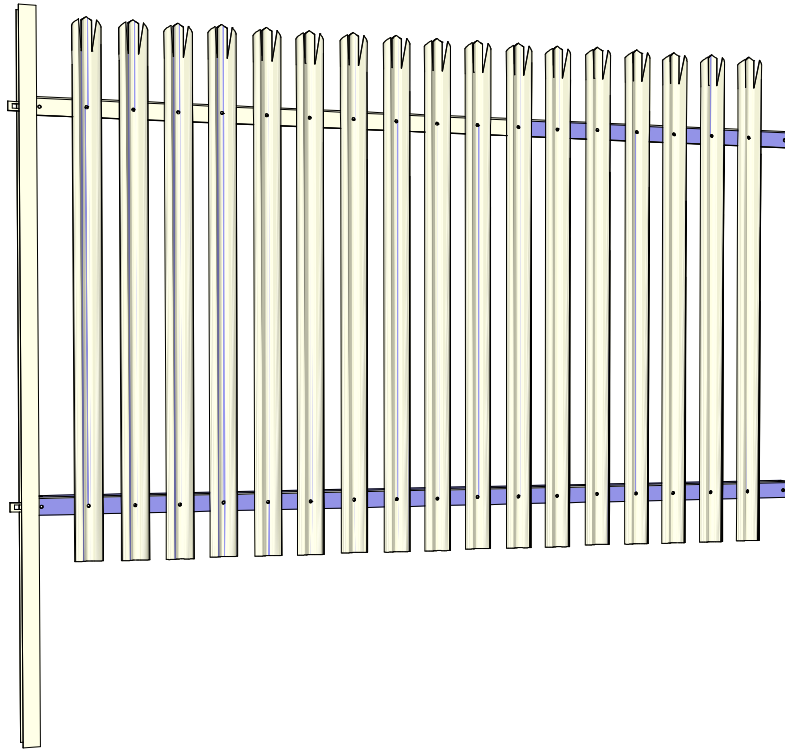

Supplied in a kit form pre galvanised
and each kit includes :

- 1 no Post
- 2 no Back Rails
- 17 no Pales
- 34 no M8 Pale Nuts & Bolts
- 4 no M12 Fish Plate Nuts & Bolts
- 2 no Fish Plates

STEEL PALISADE FENCING



Not to scale. Property of AA Fencing UK LTD
Drawn by : Barry Connolly

September 28, 2022

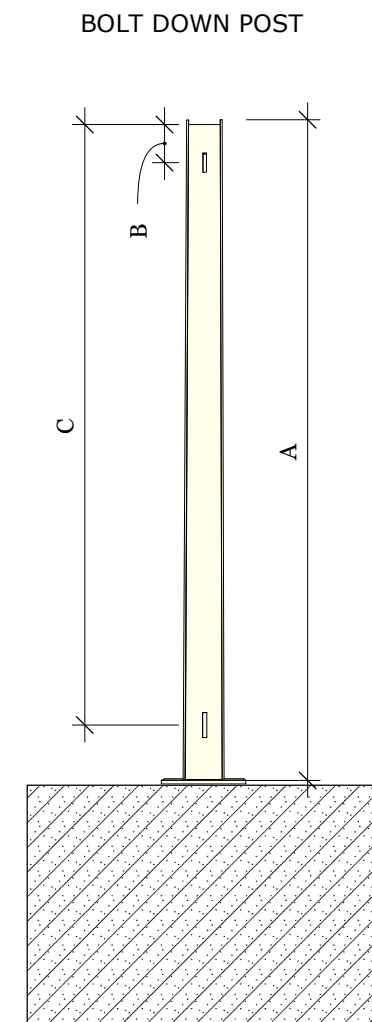
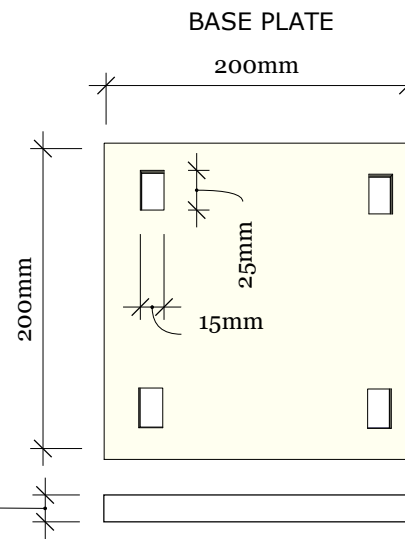
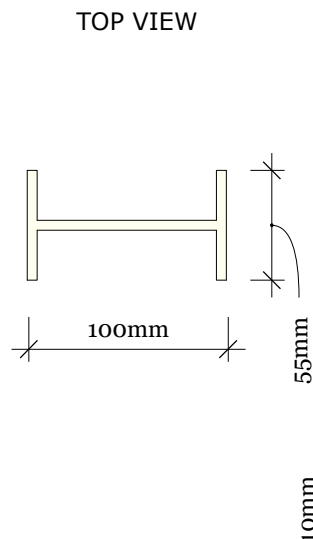
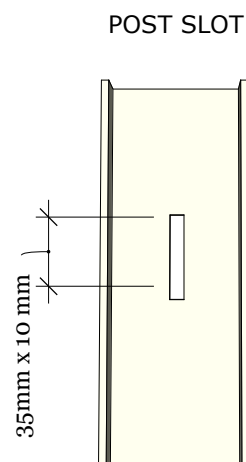
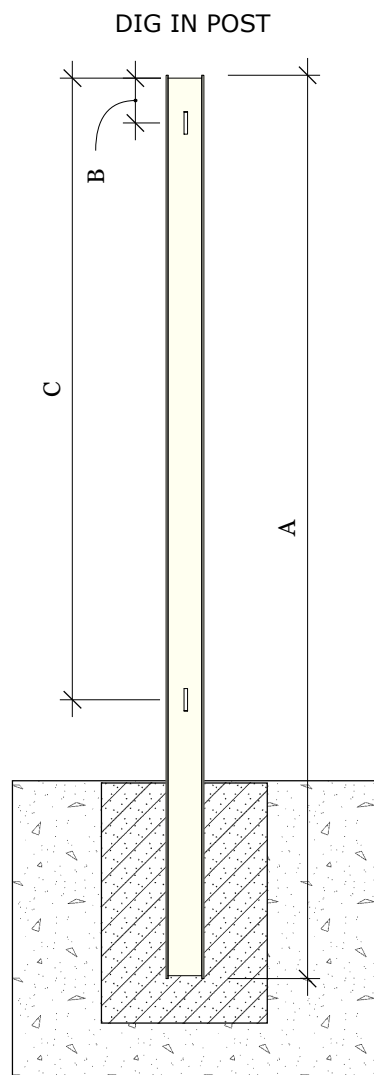

Fence Height	A - Dig In	A - Bolt Down	B	C
1200mm	1800mm	1200mm	225mm	1000mm
1500mm	2100mm	1500mm	225mm	1300mm
1800mm	2400mm	1800mm	295mm	1600mm
2000mm	2600mm	2000mm	295mm	1800mm
2100mm	2700mm	2100mm	295mm	1800mm
2400mm	3000mm	2400mm	300mm	2140mm
3000mm	3600mm	3000mm	475mm	2570mm

STEEL PALISADE POSTS



Not to scale. Property of AA Fencing UK LTD
Drawn by : Barry Connolly

September 28, 2022

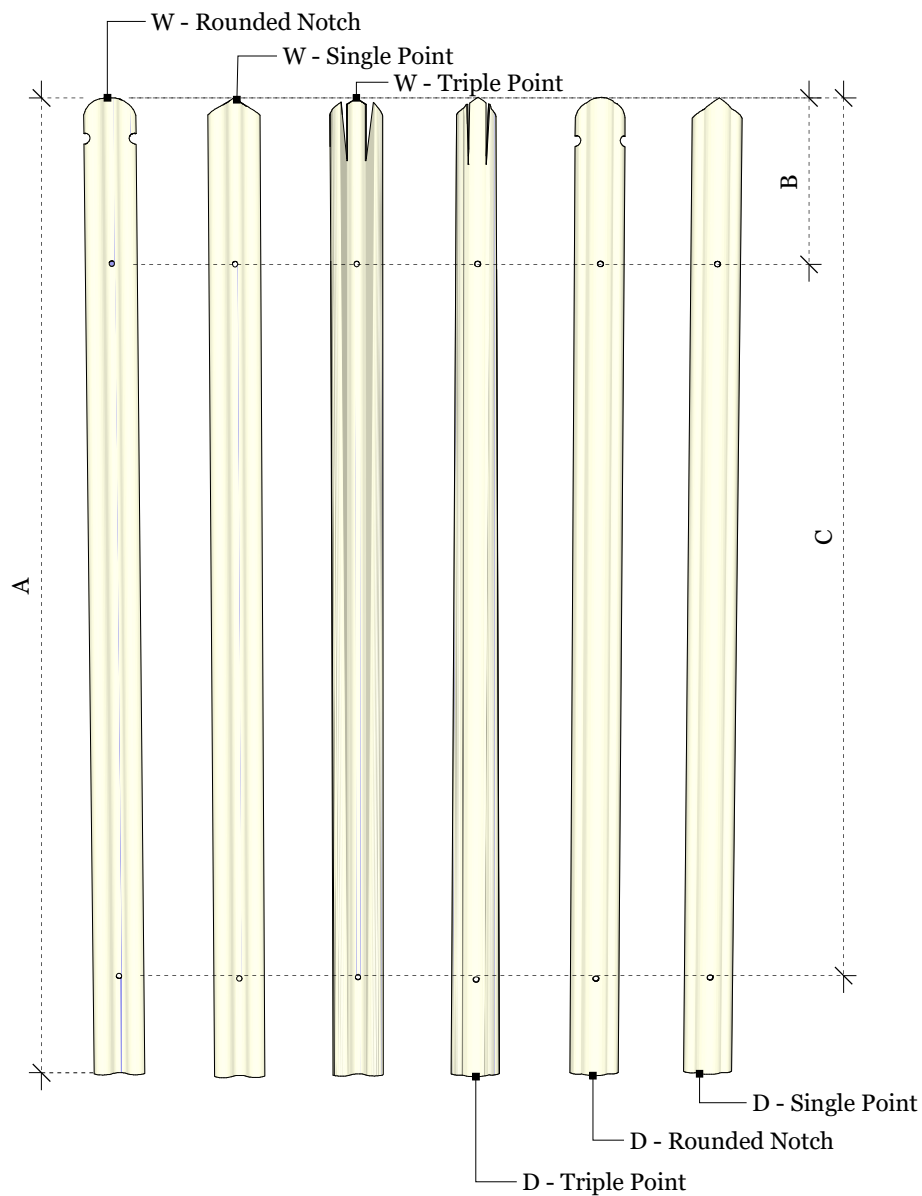

W Profile



D Profile



Fence Height	A - Pale Height	B	C
1200mm	1150mm	225mm	1000mm
1500mm	1450mm	225mm	1300mm
1800mm	1750mm	295mm	1600mm
2000mm	1950mm	295mm	1800mm
2100mm	2050mm	295mm	1800mm
2400mm	2350mm	300mm	2140mm
3000mm	2950mm	475mm	2570mm

STEEL PALISADE PALES



Not to scale. Property of AA Fencing UK LTD
 Drawn by : Barry Connolly

September 28, 2022

STRAIGHT FISH PLATE

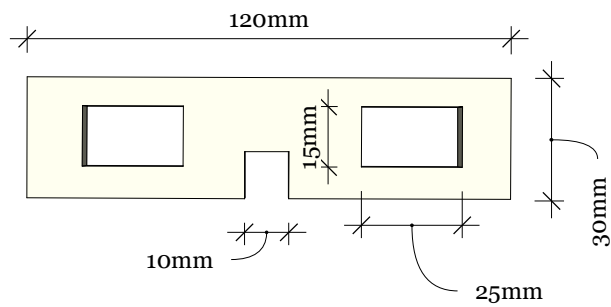

END FISH PLATE

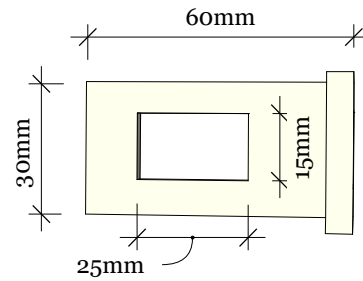

FISH PLATE CORNER

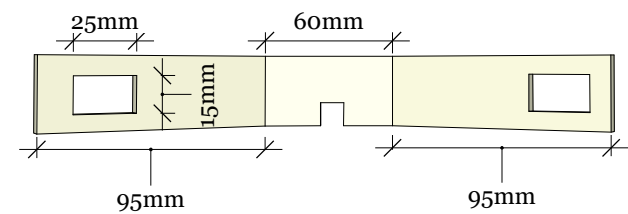

STEEL PALISADE BACK RAIL

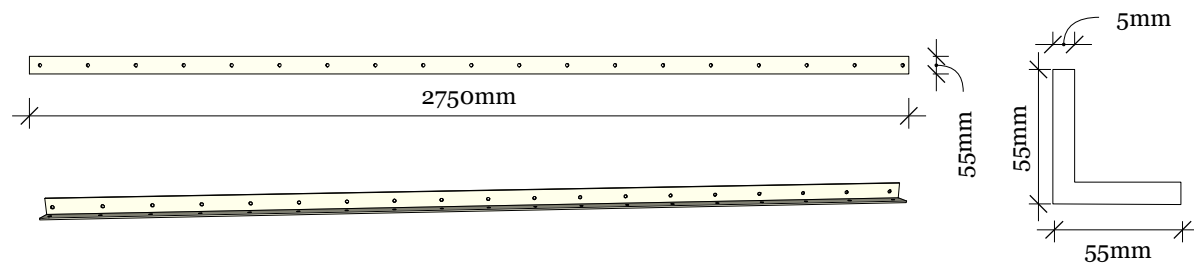

D SECTION BOLT

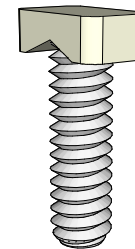

W SECTION BOLT

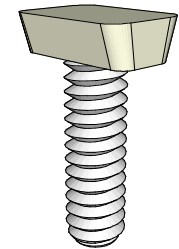

STEEL PALISADE FITTINGS



Not to scale. Property of AA Fencing UK LTD
Drawn by : Barry Connolly

September 28, 2022